



Comune di Pontassieve

zio <sup>11</sup> DANTE AUGHIERI

etto:

MONTELORO

ROSIGNANO

e

anno



This topographic map illustrates a residential development project. The map features contour lines indicating elevation, with labels ranging from 494 to 523. A central area is shaded with diagonal hatching, likely representing a water body or a specific land use. Several building footprints are shown, each with a unique hatching pattern. The map is divided into several sections by green lines, and various annotations are present:

- Red Annotations:** Multiple instances of "2004/1272" and "2006/628" are scattered across the map, indicating specific project phases or permits.
- Blue Annotation:** "2005/1274" is highlighted in a blue box near the bottom center.
- Yellow Circles:** Numbered yellow circles (1 through 16) are placed at various points on the map, possibly marking key locations or survey points.
- Black Annotations:** "T5", "S6", "T6", and "S5" are labeled near specific features or structures.
- Green Lines:** These lines delineate different areas or boundaries within the development.
- Topographic Features:** Contour lines and a central hatched area provide geographical context.

In the bottom right corner, the text "RUR" and "STATO DI PROGETTO" is visible, indicating the project's status and location.

LOCALITÀ "ROSIGNANO"

PdL (2004/319)

CU (2024/P38)

RUR  
STATO DI PROGETTO



LOTTO OGGETTO  
VENEGONO, 114  
PLAN 368

MANIFESTE (PLAN 368)

Per i lotti

5/13 sistemazione esterna

11/13 sistemazione esterna

NON È STATA DEPOSITATA  
ISTANZA DI SANAZIONE  
VERIFICARE OVVIO PROCEDIMENTO  
PLAN ⇒ ONA. DENUNCIAZIONE  
OGGI OVVIO PROCEDIMENTO  
NON RECEVUTA RAC RE

LOTTO 12/A (PENGOLATO)  
ATA 2009/1369  
PENGOLATO - PUNGOLATO

LOTTO 1/B (PENGOLATO/GAZZARO)  
ATA 2009/1371  
mt. esterno e tettoie pungolo

LOTTO 4/A + 4/B (emissione VOL)  
CSA 2009/382  
completamento, tettoie  
cont. tolleranze 23 km R.E.  
emissione volume (4/A + 4/B)  
la completa mc 0,95

LOTTO 2/B (NON COMPLETO  
VENEGONO, 114)  
ATA 2009/1371  
Sistemazione esterna

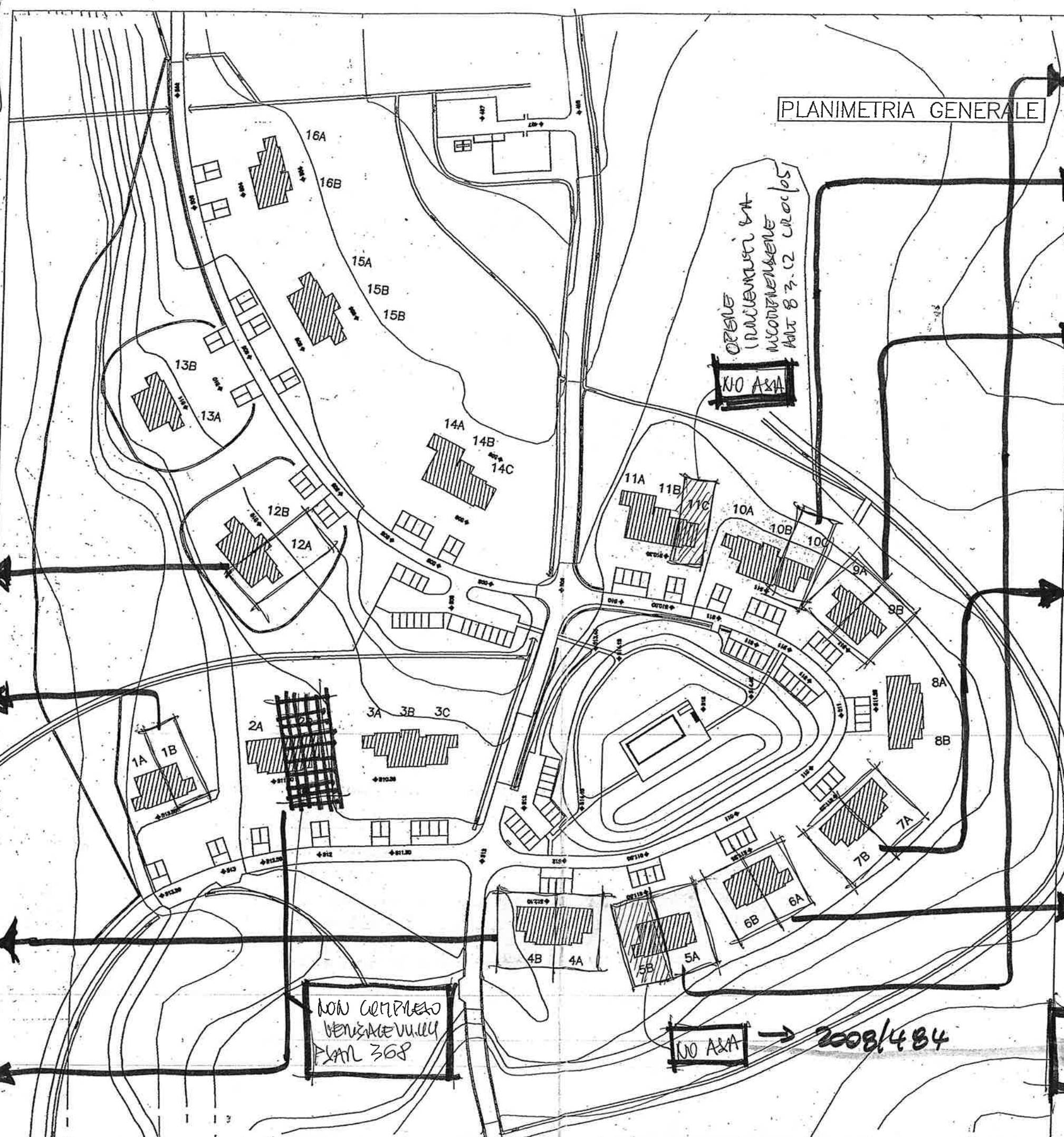

LOTTO 5/A - 5/B (SIST. ESTERNA)  
5/13 ⇒ NO ASA  
5/A → ASA 2009/1371 mt. esterno

LOTTO 10/C (MURLO CA, x QUERQU)  
CSA 2009/379 - Tuo potestade quere

LOTTO 9/A - 9/B (AUMENTO VOL + SIST.  
ESTERNA + PUNGOLATO)  
9/A • CSA 2009/378 Tuo quere  
• CSA 2009/380 aumento VOL  
cont. tolleranze 23 km R.E.  
mt. volume mc 2,76  
• ASA 2009/1370 mt. esterno  
9/B • CSA 2009/370 Tuo quere

LOTTO 7/B - 7/A (VOL VOL + SIST. EST)  
7/A • CSA 2009/381 aumento VOL  
cont. tolleranze e LOTTO 7/A - 7/B  
emissione mc 1,12  
7/B • CSA 2009/381 idem c.d.  
x LOTTO 7/A  
• ASA 2009/1371 → PENGOLATO

LOTTO 6/A - 6/B (SIST. EST + GAZZARO)  
6/A • ASA 2009/1371 mt. esterno  
6/B • ASA 2009/1371 mt. esterno  
+ PENGOLATO

2008/484  
PENGOLATO CONTINUA  
LOTTO 13/A  
ANALISI ESTERNA  
↓  
X/1370

NO ASA → 2008/484